



型号(①代码·②NO.)
STWP4-9

■请按步骤①~②选择型号和参数后进行订购。



型号区分: ④
5天发货

■C型挡圈(孔用)

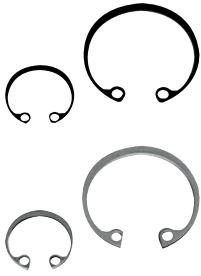

EARWN
EARWS (不锈钢)

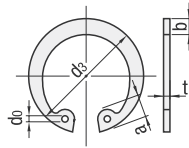

适用孔

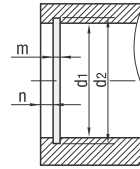
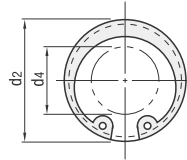

代码	材质	硬度
EARWN	弹簧钢	44~53HRC
EARWS	SUS304-CSP	36~44HRC

型号		挡圈							参考	适用孔(参考)					
①代码	②No.	d3	公差	t	公差	b (约)	a (约)	d0 (最小)	d4	d1	d2	公差	m	公差	n (最小)
EARWN EARWS (不锈钢)	10	10.7	±0.18	1	±0.05	1.5	2.8	1.2	4	10	10.4	+0.11 0	1.15	+0.14 0	1.5
	11	11.8					3		4	11	11.4				
	12	13				3.1	1.5	5	12	12.5					
	13	14.1						6	13	13.6					
	14	15.1				3.6	1.7	7	14	14.6					
	15	16.2						8	15	15.7					
	16	17.3				3.7	2	8	16	16.8					
	17	18.3						9	17	17.8					
	19	20.5				4	2	11	19	20					
	20	21.5						12	20	21					
	21	22.5	4.1	2	12	21	22								
	22	23.5			13	22	23								
	24	25.9	4.3	2	15	24	25.2								
	25	26.9			16	25	26.2								
	26	27.9	4.6	2	16	26	27.2								
	28	30.1			18	28	29.4								
	30	32.1	4.7	2	20	30	31.4								
	32	34.4			21	32	33.7								
	35	37.8	5.2	1.5	24	35	37								
	37	39.8			26	37	39								
	40	43.5	5.7	1.75	28	40	42.5								
	42	45.5			30	42	44.5								
	45	48.5	5.9	1.75	33	45	47.5								
	47	50.5			34	47	49.5								
	52	56.2	6.5	2	39	52	55								
	55	59.2			41	55	58								
	60	64.2	6.8	2	46	60	63								
	62	66.2			48	62	65								
	68	72.5	6.9	2	53	68	71								
	72	76.5			57	72	75								
	80	85.5	7	8	64	80	83.5	+0.35 0	2.7	2.5					